

# 2023 NAM Miss Alabama, Louisiana, & Mississippi Junior Pre-Teen Pageant

\*indicates required event, more info & map on back

DAY	TIME	EVENT	LOCATION	OUTFIT	EXTRA INFO
Friday May 26	3:30-5:30pm	<b>*Pageant Check-In</b>	Pre-Function (Level 2)	Your Choice (Casual)	Download pageant weekend paperwork forms from namstateinfo.com & complete them to turn in at Check-In. Also bring payment for any fees you owe, (no checks). Contestant & one parent only.
	4:00-5:30pm	<b>Talent Practice</b>	Main Stage	Casual Clothes	For those participating in the optional talent contest who wish to run through their talent on stage. Bring your music with you to practice Talent. Contestants should come after they have checked-in & received their contestant number.
	5:45-6:45pm	<b>Crash Course Training</b> (Optional)	Main Stage	Casual Clothes or Prod. Outfit	For those who would like extra practice & feedback. Cost is \$25 for the contestant. One parent or guardian must attend with each Jr Pre-Teen contestant who chooses to participate.
	7:00-7:45pm	<b>*Kick-off Orientation &amp; Group Photo</b>	Main Stage	Production Outfit	We will review the weekend ahead! A fun group photo will be taken of your age division, & you will be able to pre-order this special keepsake for \$20 during Check-in. Parent & contestant should attend.
	8:15-8:45pm	<b>Patriotic Party</b> (Optional)	Main Stage	Red, White, & Blue	One parent must attend with the Jr Pre-Teen contestant. A fun way to begin pageant weekend!
Saturday May 27	8:30-8:45am	<b>Actress Contest</b> (Optional)	Main Stage	Production Outfit	A parent brings contestant in & helps her find her emcee card in her seat, then parents have a seat in the audience. Once she has performed, she is free to go or can stay to watch friends.
	9:00-9:30am	<b>Talent Contest</b> (Optional)	Main Stage	Talent Outfit	A parent brings contestant in & helps her find her emcee card in her seat, then parents have a seat in the audience. Once she has performed, she is free to go or can stay to watch friends.
	9:45-10:00am	<b>Casual Wear Contest</b> (Optional)	Main Stage	Casual Wear Outfit	A parent brings contestant in & helps her find her emcee card in her seat, then parents have a seat in the audience. Once she has performed, she is free to go or can stay to watch friends.
	10:15-10:30am	<b>Fun Fitness Contest</b> (Optional)	Main Stage	Fun Fitness Outfit	A parent brings contestant in & helps her find her emcee card in her seat, then parents have a seat in the audience. Once she has performed, she is free to go or can stay to watch friends.
	10:45-12:00pm	<b>Top Model &amp; Media Correspondent Contest</b> (Optional)	Meeting Room 2	Top Model/Med. Corresp. Outfit	A parent should bring contestant to designated area outside of event space, remove contestant number, have contestant hold number to bring in with her. A staff member will come get each contestant. At Pageant Check-in, you will receive a specific time to arrive within the timeframe listed to the left.
	12:30-12:45pm	<b>Spokesmodel Contest</b> (Optional)	Amphitheater	Spokesmodel Outfit	A parent brings contestant in & helps her find her emcee card in her seat, then parents have a seat in the audience. Once she has performed, she is free to go or can stay to watch friends.
	3:30-4:30pm	<b>*Opening # Rehearsal</b>	Pre-Function (Level 2)	Casual Clothes	A parent or guardian must attend with the Jr Pre-Teen contestant.
	5:00-6:00pm	<b>*Formal Wear &amp; Personal Intro Rehearsal</b>	Main Stage	Casual Clothes	Contestants will practice for these competitions. They are welcome to wear the shoes they will compete in to practice with. Escorts should attend as they will practice escorting their contestant.
	7:10pm	<b>*Lineup for Formal Wear Competition</b>	Main Stage	Formal Dress	Wear formal dress. Contestant & escort should go to Main Stage & find emcee card in a chair & be seated. Escorts may wear a suit, tuxedo, formal dress or skirt, military uniform, or Sunday best.
	7:30-8:30pm	<b>*Formal Wear w/ Escort Competition</b>	Main Stage	Formal Dress	After Formal Wear is presented, the Spotlight/Feature pages contest & Spirit of Pageantry awards will be presented.

CONTINUED ON BACK

Sunday May 28	8:00-8:30am	<b>*Personal Introduction Competition</b>	Main Stage	Interview Outfit	Bring contestants, (in the interview outfit), into the ballroom & help them find their emcee card in their seat. Parents will sit in the audience to watch their Personal Introductions.
	8:45-9:45am	<b>*Interview Competition &amp; Parent Meeting</b>	Intvw: Mtg Rm 3 Parents: Amphitheater	Interview Outfit	After Personal Introduction, contestants remain backstage & are taken to Interview by Staff. Parents go to Amphitheater & wait for them & hear from State Director to review the Final Show. Only 1 person per contestant in Amphitheater.
	11:30-12:00pm	<b>Runway Contest (Optional)</b>	Main Stage	Runway Outfit	A parent brings contestant in & helps her find her emcee card in her seat, then parents have a seat in the audience. Once she has performed, she will stay backstage for the final walk after all the contestants have performed.
	1:15-2:15pm	<b>*Rehearsal for Final Show</b>	Main Stage	Casual Clothes	Contestants & one parent to attend. We will go over the Final Show.
	4:30pm	<b>*Report to the Dressing Room for Final Show</b> <i>(Contestant &amp; one female adult)</i>	Meeting Room 1	Wear Production Outfit & bring Formal Dress	Wear production # outfit & bring formal dress & shoes to dressing room. Female parent will stay with daughter in dressing room until right before show begins. After opening number, female parent will go with her back to dressing room to quickly change her into her dress. DO NOT put contestant number on production number outfit. Have it on her formal dress.
	5:00-6:15pm	<b>*Final Show</b>	Main Stage	Production Outfit & Formal Dress	<u>Everyone</u> three or older needs a ticket (except contestant in that Finale). General admission seating. A sign near ballroom indicates where line begins. Contestants perform their dance number, walk in their gown again, then Optional awards & crowning!

## IMPORTANT REMINDERS

- Do not leave children unattended & do not leave any personal items unattended. NAM is not responsible for lost or stolen items including in the dressing room.
- No one is allowed backstage or onstage unless escorted by a staff person.
- Watch your step at all times, especially around the front row of chairs & around the stage.
- The Production Outfit is a NAM shirt & socks purchased at check-in. Wear with your own denim shorts & white tennis shoes. Schedule indicates when to wear the Production Outfit.
- If lost items are found, they will either be turned in at the hotel front desk or the NAM Boutique.
- Videotaping & flash photography are not permitted during competitions or rehearsals, (this includes cell phone photography & videotaping).
- The only event that requires a ticket is the Final Show. Everyone over the age of three, (except the Contestant competing in that show), must have a ticket to the Final Show. Tickets can be purchased at the Boutique as long as supplies last.
- Contestants should wear their contestant number badge for all competitions. They receive badge at check-in. If you lose your badge, obtain a replacement for \$3 at the NAM Boutique.
- Escorts are NOT needed for the Final Show. Escorts are only needed for the Formal Wear with Escort Competition.
- Take a photo of your schedule with your phone so you will always have it with you.
- Dressing room is intended for quick changes. Do not leave valuables in dressing room, door is not locked. No curling irons or other hot appliances in dressing room. Only Contestant & one female helper allowed in dressing room. NAM is not responsible for lost or stolen items. Dressing room will be available whenever onstage competitions are underway.

## FIRST FLOOR

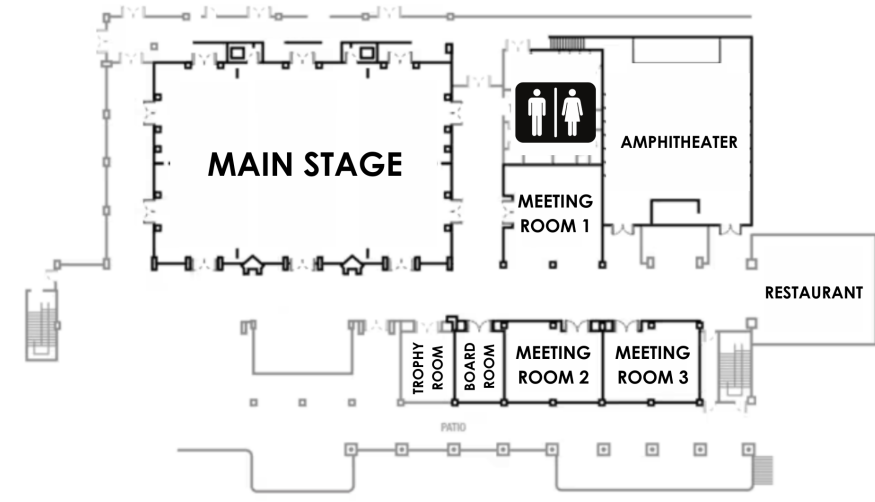

## SECOND FLOOR

